

Specifications:

Current Rating:7.0A AC/DC
 Voltage Rating:250V AC/DC
 Contact Resistance:20m ohm.Max.
 Insulation Resistance:1000M ohm.Min.
 Withstanding Voltage:1500V AC/Minute
 Operating Temperature Range:-40°C To + 105°C

Material and Finish:
 Insulator:Nylon 66 (UL94V-2)
 Insulator Color:White
 Contact:Brass
 Plating:Tin Plated

How To Order
 WFV508-XX

└── No. of Positions
 └── S: Straight Type

| POS. | DIM.A | DIM.B | POS. | DIM.A | DIM.B |
|------|-------|-------|------|-------|-------|
| 2 | 10.16 | 5.08 | 8 | 40.64 | 35.56 |
| 3 | 15.24 | 10.16 | 9 | 45.72 | 40.64 |
| 4 | 20.32 | 15.24 | 10 | 50.80 | 45.72 |
| 5 | 25.40 | 20.32 | 12 | 60.96 | 55.88 |
| 6 | 30.48 | 25.40 | | | |
| 7 | 35.56 | 30.48 | | | |

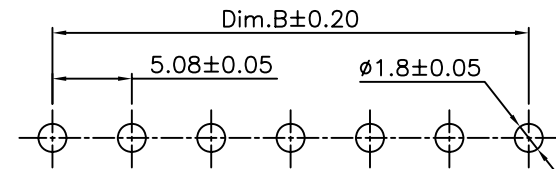

P.C.B Layout

RoHS Compliant

| | | | | |
|-----|-------------|---------------|-----|------------------------|
| F | | | | DRAWN: Ken |
| E | | | | |
| D | | | | |
| C | | | | CHECKED: Lily Chou |
| B | 23-Nov-2021 | Amend Plastic | Ken | APPROVAL: Chao Peng |
| A | 01-SEP-2009 | (PC0001) | Ken | |
| REV | DATE | FILE | BY | |

| | |
|---|----------------------------------|
| GENERAL TOLERANCE: .X=±0.30 .XX=±0.20 | |
| UNIT: MM | DESCRIPTION: 5.08mm Header |
| SCALE: 1:1 | Straight Type With Friction Lock |
| SHEET: 1 / 1 | PART NO: WFV508-XX |
| PROJECTION: | |

| | | |
|--|--|-----------|
| | | SIZE |
| | | A4 |