

SPECIFICATIONS:

Current Rating:7.0A AC,DC
 Voltage Rating:250V AC,DC
 Contact Resistance:20M ohm max
 Insulation Resistance:1000M ohm min
 Withstanding Voltage:1500V AC/minute
 Temperature Range:-25°C to +125°C

Material:

Insulator:Nylon 66(UL94V-2)

Contact:Brass

Finish:Tin Plated

How to order

WFV508-XX-01

01:W/O Lock

No:of Position:2-12Ways

V:Straight Type

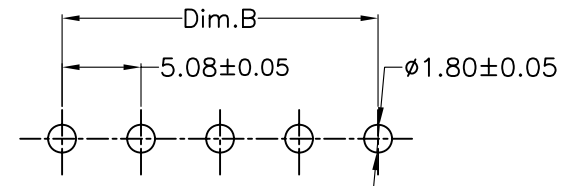

PCB Layout

Circuits	Dim.A	Dim.B	Circuits	Dim.A	Dim.B
2	10.16	5.08	8	40.64	35.56
3	15.24	10.16	9	45.72	40.64
4	20.32	15.24	10	50.80	45.72
5	25.40	20.32	12	60.96	55.88
6	30.48	25.40			
7	35.56	30.48			

RoHS Compliant

F				DRAWN: Ken	GENERAL TOLERANCE: .X=±0.20 .XX=±0.15		DESCRIPTION: 5.08mm Wafer Straight Type	SIZE A4
E								
D				CHECKED: Lily Chou	UNIT: MM	PART NO: WFV508-XX-01		
C					SCALE: 1:1			
B				APPROVAL: Chao Peng	SHEET: 1 / 1			
A	22-May-2017	(PC0001)	Ken		PROJECTION:			
REV	DATE	FILE	BY					