

Specifications:
 Current Rating:7.0A AC,DC
 Voltage Rating:250V AC,DC
 Contact Resistance:10mohm Max
 Insulation Resistance:1000Mohm Min.
 Withstanding Voltage:1500V AC/minute
 Operating Temperature Range:-40°C~+105°C
 Material and Finish:
 Insulator:Nylon 66 (UL94V-0)
 Contact:Brass
 Plating:Tin Plated

How to Order
 WFV396-XX-XX

Blank:White BK:Black RD:Red
 BU:Blue OR:Orange GN:Green
 YL:Yellow PK:Pink GR:Gray
 No.Of Positions
 Straight Type

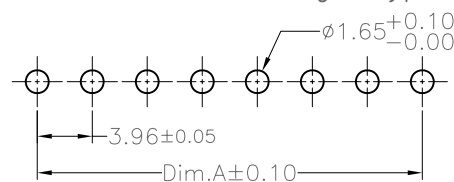

PCB LAYOUT

Dimension:

Pos.	Dimension:		Pos.	Dimension:		Pos.	Dimension:	
	A	B		A	B		A	B
02	3.96	7.86	09	31.68	35.58	16	59.40	63.30
03	7.92	11.82	10	35.64	39.54	17	63.36	67.26
04	11.88	15.78	11	39.60	43.50	18	67.32	71.22
05	15.84	19.74	12	43.56	47.46	19	71.28	75.18
06	19.80	23.70	13	47.52	51.42	20	75.24	79.14
07	23.76	27.66	14	51.48	55.38			
08	27.72	31.62	15	55.44	59.34			

RoHS Compliant

F				DRAWN:	GENERAL TOLERANCE:		DESCRIPTION: 3.96mm Wafer Single Row Straight Type	SIZE A4
E				Ken	.X=±0.20 .XX=±0.15			
D				CHECKED:	UNIT: MM			
C				Lily Chou	SCALE: 1:1			
B				APPROVAL:	SHEET: 1 / 1	PART NO:	WFV396-XX-XX	
A	01-SEP-2009	(PC0001)	Ken	Chao Peng	PROJECTION:			
REV	DATE	FILE	BY					