

1

2

3

4

5

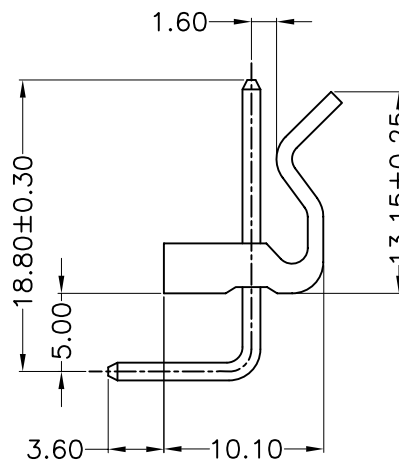
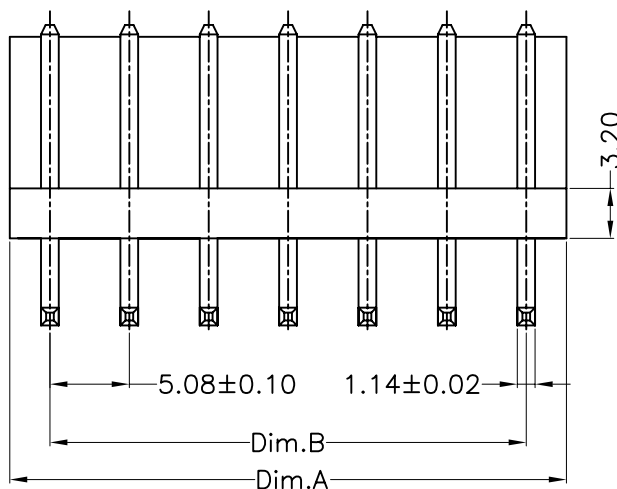
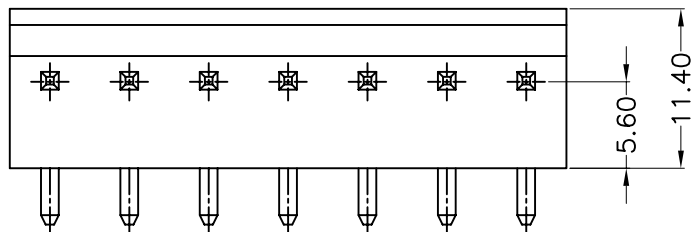

Specifications:

Current Rating:7.0A AC/DC

Voltage Rating:250V AC/DC

Contact Resistance:20m ohm.Max.

Insulation Resistance:1000M ohm.Min.

Withstanding Voltage:1500V AC/Minute

Operating Temperature Range:-40°C To + 105°C

Material and Finish:

Insulator:Nylon 66 (UL94V-2)

Insulator Color:White

Contact:Brass

Plating:Tin Plated

How To Order

WFR508-XX

└── No. of Positions
└── R/A Type

POS.	DIM.A	DIM.B	POS.	DIM.A	DIM.B	POS.	DIM.A	DIM.B
2	10.16	5.08	6	30.48	25.40	10	50.80	45.72
3	15.24	10.16	7	35.56	30.48	12	60.96	55.88
4	20.32	15.24	8	40.64	35.56			
5	25.40	20.32	9	45.72	40.64			

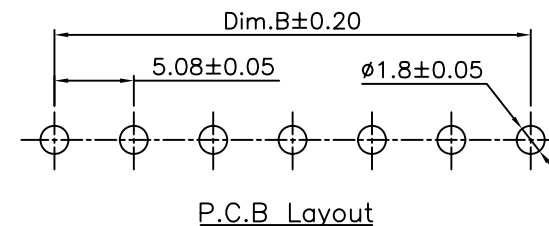

RoHS Compliant

F				DRAWN:	GENERAL TOLERANCE:			SIZE
E				Ken	.X=±0.30 .XX=±0.20			
D				CHECKED:	UNIT: MM	DESCRIPTION: 5.08mm Header R/A Type With Friction Lock		A4
C				Lily Chou	SCALE: 1:1			
B				APPROVAL:	SHEET: 1 / 1	PART NO: WFR508-XX		
A	01-SEP-2015	(PC0001)	Ken	Chao Peng	PROJECTION:			
REV	DATE	FILE	BY					