

**SPECIFICATIONS:**

Current Rating:7.0A AC,DC  
 Voltage Rating:250V AC,DC  
 Contact Resistance:20M ohm max  
 Insulation Resistance:1000M ohm min  
 Withstanding Voltage:1500V AC/minute  
 Temperature Range:-25°C to +125°C

**Material:**

Insulator:Nylon 66(UL94V-2)

Contact:Brass

Finish:Tin Plated

How to order

WFR508-XX-01

01:W/O Lock

No:of Position:2-12Ways

R:Right Angle

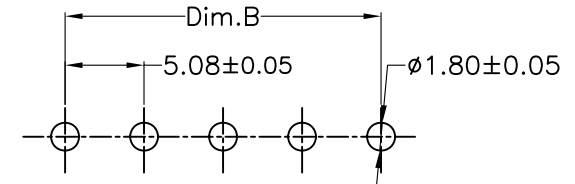

PCB Layout

POS.	DIM.A	DIM.B	POS.	DIM.A	DIM.B	POS.	DIM.A	DIM.B
2	10.16	5.08	6	30.48	25.40	10	50.80	45.72
3	15.24	10.16	7	35.56	30.48	12	60.96	55.88
4	20.32	15.24	8	40.64	35.56			
5	25.40	20.32	9	45.72	40.64			

RoHS Compliant

F				DRAWN:	GENERAL TOLERANCE:		DESCRIPTION:	SIZE
E				Ken	.X=±0.20 .XX=±0.15			
D				CHECKED:	UNIT: MM	5.08mm Wafer R/A Type	A4	
C				Lily Chou	SCALE: 1:1			
B				APPROVAL:	SHEET: 1 / 1	PART NO:	WFR508-XX-01	
A	22-May-2014	(PC0001)	Ken	Chao Peng	PROJECTION:			
REV	DATE	FILE	BY					