

Specifications:
 Current Rating:9.5A AC/DC
 Voltage Rating:600V AC/DC
 Contact Resistance:10m ohm. Max.
 Insulation Resistance:1000M ohm. Min.
 Withstanding Voltage:1500V AC For One Minute
 Operating Temperature Range:-40°C To +105°C
 Materials:

Insulator:Nylon 66 (UL94V-0)
 Insulator Color:White
 Contact:Brass
 Plating:Tin Plated
 How To Order:
 WFDR414-04X

T: Tin Plated
 G: Gold Plated
 No. of Contacts
 Double Row R/A Type

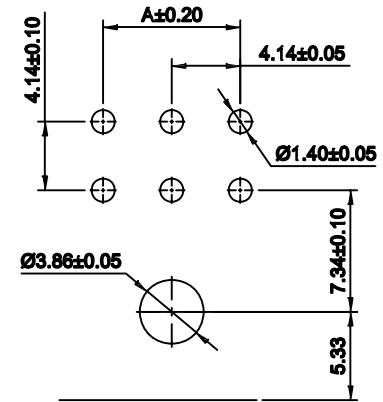

Ordering Information & Dimensions

Circuits	Dimensions(mm)		Circuits	Dimensions(mm)	
	A	B		A	B
2x2P	4.14	9.83	2x5P	16.56	22.25
2x3P	8.28	13.97	2x6P	20.70	26.39
2x4P	12.42	18.11			

RoHS Compliant

F				DRAWN:	GENERAL TOLERANCE:		DESCRIPTION:	SIZE	
E				Andrew	.X=±0.20 .XX=±0.15				
D				CHECKED:	UNIT: MM				4.14mm Power Wafer Dip R/A Type
C				Jeremy Liu	SCALE: 1:1				
B				APPROVAL:	SHEET: 1 / 2	PART NO:	A4		
A	22-Oct-2018	(PC0001)	Andrew	Mike Wu	PROJECTION:	WFDR414-XXX			
REV	DATE	FILE	BY						