

Specifications:
 Current Rating:3.0A AC,DC
 Voltage Rating:250V AC,DC
 Contact Resistance:20mohm Max
 Insulation Resistance:1000Mohm Min.
 Withstanding Voltage:1000V AC/minute
 Operating Temperature Range:-40°C~+105°C
 Material And Finish:
 Insulator:High Temp,Plastic (Nylon 9T UL94V-0)
 Insulator Color:Black
 Contact:Brass
 Plating:Gold Plated
 How To Order
 WF2RSM254-XXG
 G:Gold Plated
 No. Of Positions
 RSM:R/A SMT Type

Circuits	Dim.A	Dim.B	Dim.C	Dim.D	Circuits	Dim.A	Dim.B	Dim.C	Dim.D
2	2.54	5.58	8.89	5.33	8	17.78	20.83	24.13	20.57
3	5.08	8.13	11.43	7.87	9	20.32	23.37	26.67	23.11
4	7.62	10.67	13.97	10.41	10	22.86	25.91	29.21	25.65
5	10.16	13.21	16.51	12.95	11	25.40	28.45	31.75	28.19
6	12.70	15.75	19.05	15.49	12	27.94	30.99	34.29	30.73
7	15.24	18.29	21.59	18.03					

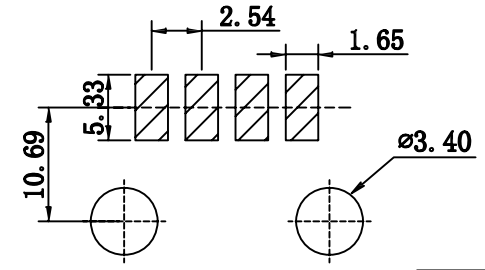

PCB LAYOUT

RoHS Compliant

F			
E			
D			
C			
B			
A	12-Oct-2014	(H0050)	Ken
REV	DATE	FILE	BY

DRAWN: Ken
 CHECKED: Lily Chou
 APPROVAL: Chao Peng
 PROJECTION:

GENERAL TOLERANCE:
 .X=±0.20
 .XX=±0.15
 UNIT: MM
 SCALE: 1:1
 SHEET: 1 / 1

DESCRIPTION:
 2.54mm Pocket Header R/A SMT Type
 PART NO: WF2RSM254-XXG

SIZE
A4