

Specifications:
 Current Rating:7.0A AC,DC
 Voltage Rating:250V AC,DC
 Contact Resistance:10mohm Max
 Insulation Resistance:1000Mohm Min.
 Withstanding Voltage:1500V AC/minute
 Operating Temperature Range:-40°C~+105°C
 Material And Finish:

Insulator:Nylon 66 (UL94V-2)
 Insulator Color:Transparence White
 Contact:Brass
 Plating:Tin Plated

How to Order
 WF1R396-XX-01

Without Lock
 No.Of Positions
 Right Angle Type

Pos	Dim. A	Dim. B	Pos	Dim. A	Dim. B	Pos	Dim. A	Dim. B
2	3.96	7.92	9	31.68	35.64	16	59.40	63.36
3	7.92	11.88	10	35.64	39.60	17	63.36	67.32
4	11.88	15.84	11	39.60	43.56	18	67.32	71.28
5	15.84	19.80	12	43.56	47.52	19	71.28	75.24
6	19.80	23.76	13	47.52	51.48	20	75.24	79.20
7	23.76	27.72	14	51.48	55.44			
8	27.72	31.68	15	55.44	59.40			

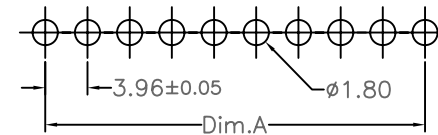

PCB LAYOUT

RoHS Compliant

F				DRAWN:	GENERAL TOLERANCE:		DESCRIPTION:	SIZE
E				Ken	.X=±0.30			
D				CHECKED:	.XX=±0.20			
C				Lily Chou	UNIT: MM			
B				APPROVAL:	SCALE: 1:1	DESCRIPTION:	3.96mm Wafer R/A Type	A4
A	01-SEP-2009	(PC0001)	Ken	Chao Peng	SHEET: 1 / 1	PART NO:	WF1R396-XX	
REV	DATE	FILE	BY		PROJECTION:			