

Specifications:
 Current Rating: 7.0A AC, DC
 Voltage Rating: 250V AC, DC
 Contact Resistance: 10mohm Max
 Insulation Resistance: 1000Mohm Min.
 Withstanding Voltage: 1500V AC/minute
 Operating Temperature Range: -40°C ~ +105°C
 Material And Finish:
 Insulator: Nylon 66 (UL94V-2)
 Insulator Color: Transparence White
 Contact: Brass
 Plating: Tin Plated
 How to Order
 WF1R396-XX-01-9931
 Without Lock
 No. Of Positions
 Right Angle Type

Pos	Dim. A	Dim. B	Pos	Dim. A	Dim. B	Pos	Dim. A	Dim. B
2	3.96	7.92	9	31.68	35.64	16	59.40	63.36
3	7.92	11.88	10	35.64	39.60	17	63.36	67.32
4	11.88	15.84	11	39.60	43.56	18	67.32	71.28
5	15.84	19.80	12	43.56	47.52	19	71.28	75.24
6	19.80	23.76	13	47.52	51.48	20	75.24	79.20
7	23.76	27.72	14	51.48	55.44			
8	27.72	31.68	15	55.44	59.40			

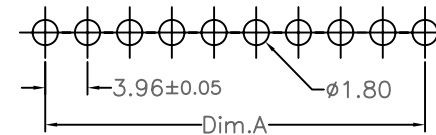

PCB LAYOUT

RoHS Compliant

F				DRAWN: Ken	GENERAL TOLERANCE: .X = ±0.30 .XX = ±0.20		DESCRIPTION: 3.96mm Wafer R/A Type	SIZE A4
E								
D				CHECKED: Lily Chou	UNIT: MM	PART NO: WF1R396-XX-01-9931		
C					SCALE: 1:1			
B				APPROVAL: Chao Peng	SHEET: 1 / 1			
A	02-Mar-2017	(PC0001)	Ken		PROJECTION:			
REV	DATE	FILE	BY					