

Specifications:  
 Current Rating:1A AC/DC  
 Voltage Rating:60V AC/DC  
 Contact Resistance:5m ohm. Max.  
 Insulation Resistance:100M ohm. Min.  
 Withstanding Voltage:500V AC/Minute  
 Waterproof rate:IP67  
 Operating Temperature Range:-25°C ~ +90°C  
 Material and Finish  
 Insulator:TPU/PA+GF  
 Contact:Brass Gold Plated  
 Nut/Screw:Brass Nickel Plated  
 Seal/O-ring:Expoxy resin/FKM

How to Order  
**M5-XXX-FA-PBX**  
 PB:Panel Mount PCB Dip  
 PBS:Panel Mount PCB Dip With Shielding  
 A:A Coding  
 F:Front Fastened  
 S:Socket  
 P:Plug  
 No.of Contacts  
 M5 Series

Contact Configuration:

Pin	Contacts		Contacts Termination	Wire gauge /size		Plug PB Type PCB Layout	Sokcet PB Type PCB Layout	Plug PBS Type PCB Layout	Sokcet PBS Type PCB Layout
	Socket	Plug		AWG	mm2				
3Pin (A Coding)			PCB	26	0.14				
4Pin (A Coding)			PCB	26	0.14				

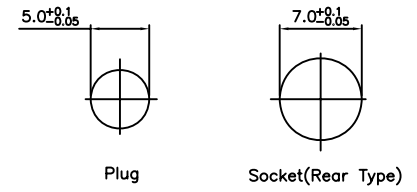

Recommended Panel Cut-Out

RoHS Compliant

F			
E			
D			
C			
B			
A	01-MAR-2019	(PC0001)	ANDREW
REV	DATE	FILE	BY

DRAWN: ANDREW	GENERAL TOLERANCE: .X=±0.2 .XX=±0.15 .XXX=±0.10
CHECKED: BILLHE	
APPROVAL: NORMAN	
PROJECTION: 	

UNIT: MM	DESCRIPTION: M5 Panec Mount/PCB/Front Fastened Connector
SCALE: 1:1	
SHEET: 1/1	
PART NO: M5-XXX-FA-PBX	



**A4**