

Part No	Wire Application	Q'ty/Reel
HS635T-1822	18AWG-22AWG	5,000PCS
HS635T-1620	16AWG-20AWG	3,500PCS

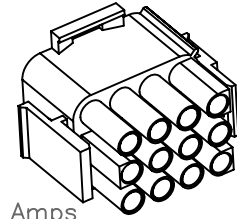

Specifications:
 Current Rating:13.0 Amps
 Voltage Rating:600V AC/DC
 Contact Resistance:20m Ohm Max
 Insulator Resistance:1000M Ohm Min
 Withstanding Voltage: 5000V AC/minute
 Operating Temperature Range:-55°C~+105°C
 Material:
 Plastic:Nylon 66 (UL94V-2)
 Contacts:Brass
 Plating:TIN Plated
 Wire range: #16~#22
 How To Order
 HS635-XX

— No. Of Postions
 — R:Receptacle

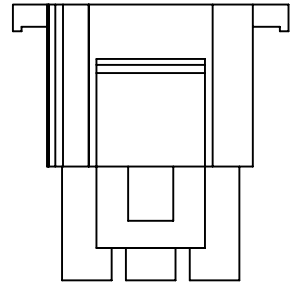
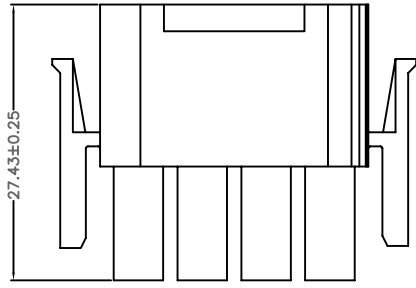

Dimension:

Circuits	Dim.A±0.25	Dim.B±0.15	Dim.C±0.25	Dim.D±0.15
2	13.97	6.35	—	14.73
3	20.32	12.70	—	14.73
4	26.67	19.05	—	14.73
5	33.02	25.40	—	14.73
6	13.97	6.35	12.70	27.43
7	45.72	38.10	—	14.73
8	52.07	44.45	—	14.73
9	20.32	12.70	12.70	27.43
10	64.77	57.15	—	14.73
12	26.67	19.05	12.70	27.43
15	33.02	25.40	12.70	27.43

RoHS Compliant

F				DRAWN:	GENERAL TOLERANCE:		DESCRIPTION: 6.35mm Dia. Socket Housing	SIZE A4
E			Ken	.X=±0.20 .XX=±0.15				
D			CHECKED:	UNIT: MM				
C			Lily Chou	SCALE: 1:1				
B			APPROVAL:	SHEET: 1 / 2	PART NO:	HS635-XX		
A	01-SEP-2012	(PC0001)	Ken	Chao Peng	PROJECTION:			
REV	DATE	FILE	BY					

1

2

3

4

5

Material: Nylon 66 (UL94V-2)
Color: White

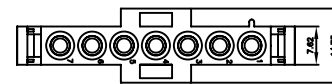
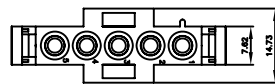
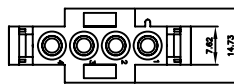
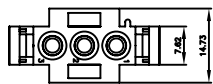
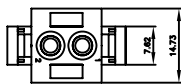
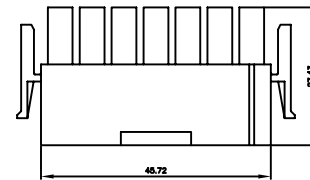
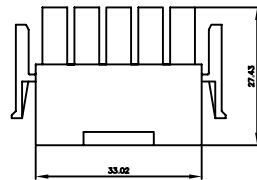
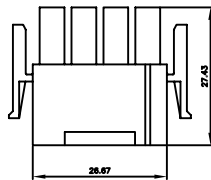
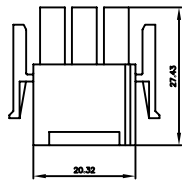
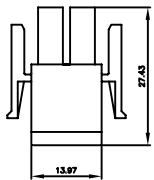

HS635-02

HS635-03

HS635-04

HS635-05

HS635-07

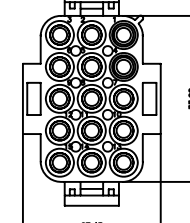
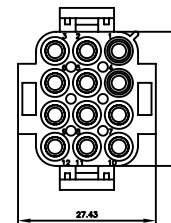
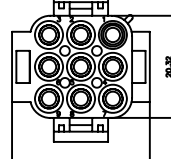
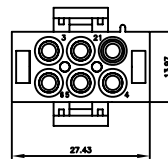
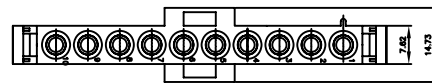
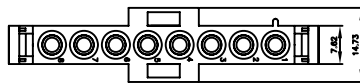
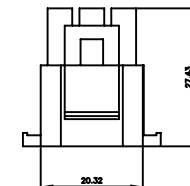
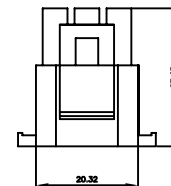
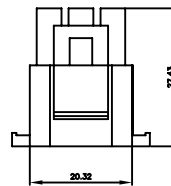
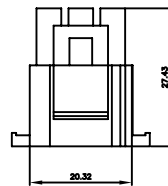
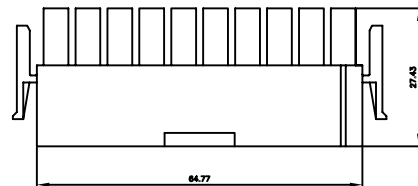
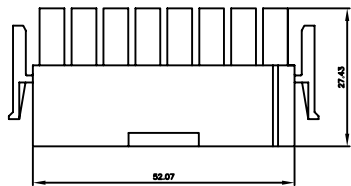

HS635-08

HS635-10

HS635-06

HS635-09

HS635-12

HS635-15

RoHS Compliant

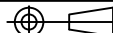
F				DRAWN: Ken	GENERAL TOLERANCE: .X=±0.20 .XX=±0.15		DESCRIPTION: 6.35mm Dia. Socket Housing	SIZE A4
E								
D				CHECKED: Lily Chou	UNIT: MM	PART NO: HS635-XX		
C					SCALE: 1:1			
B				APPROVAL: Chao Peng	SHEET: 2 / 2			
A	01-SEP-2012	(PC0001)	Ken		PROJECTION: 			
REV	DATE	FILE	BY					