

Specifications:

Current rating:3.0A AC,DC
 Voltage rating:250V AC,DC
 Contact resistance:30m ohm max.
 Insulation resistance: 5,000M ohm min.
 Withstanding voltage:1,000V AC/Minute
 Operating Temperature:-40°C ~ +85°C

Materials:
 Insulator:PBT (UL94V-0)
 Contact:Copper alloy Nickel Undercoated,
 Selective Gold plated
 Front metal shell: Nickel plated
 Rear metal shell: Tin plated

How To Order
 DBOS-XX-XX-XX

Blank:White(Standard Color)
 BK:Black; BU:Blue
 Blank:Standard type
 CS:Rear Rivet
 CC:Front Rivet
 No.Of Positions

CS Type
(Thru Hole)

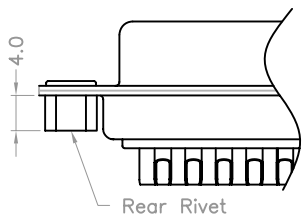

CC Type
(Not Thru Hole)

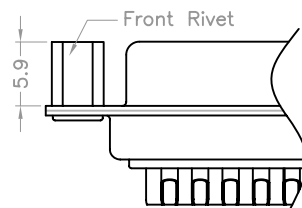

Pos	A	B	C
9	16.33	24.99	30.81
15	24.66	33.32	39.14
25	38.38	47.04	53.04
37	54.84	63.50	69.32

RoHS Compliant

E			
D			
C			
B			
A	04-Sep-2013	(H0036)	Jack Zhou
REV	DATE	FILE	BY

DRAWN: Jack Zhou	GENERAL TOLERANCE: .X=±0.2 .XX=±0.15
CHECKED: Ken Wang	UNIT: MM SCALE:2:1
APPROVAL: Make Hu	SHEET: 1 / 1 PROJECTION:

DESCRIPTION: D-SUB Solder Female Stamp Pin Type	SIZE A4
PART NO: DBOS-XX-XX-XX	