

Specifications:

Current rating:1.0A AC,DC
 Voltage rating:125V AC,DC
 Contact resistance:20m ohm.Max
 Insulation resistance:100M ohm.Min
 Withstanding voltage:250V AC/minute
 Operating temperature range:-40°C~+85°C
 Material:

Insulator:High Temp. Plastic(Nylon 46 UL94V-0)
 Insulator Color:White
 Contact:Phosphor Bronze
 Plated: Tin Plated
 Package:1000pcs/Reel
 How To Order:
 WFVSM125-XX-CR

Cap+Tape&Reel
 No.Of Position
 Straight SMT Type

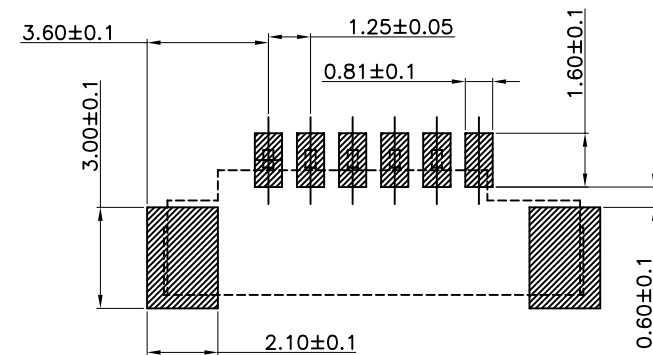
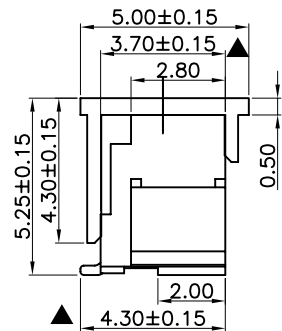
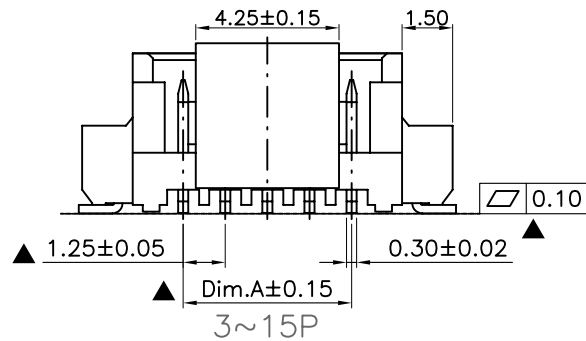

PCB LAYOUT

RoHS Compliant

Dimension:

Pos	DimA	DimB	DimC	Pos	DimA	DimB	DimC
2	1.25	7.25	4.25	9	10.00	16.00	13.00
3	2.50	8.50	5.50	10	11.25	17.25	14.25
4	3.75	9.75	6.75	11	12.50	18.50	15.50
5	5.00	11.00	8.00	12	13.75	19.75	16.75
6	6.25	12.25	9.25	13	15.00	21.00	18.00
7	7.50	13.50	10.50	14	16.25	22.25	19.25
8	8.75	14.75	11.75	15	17.50	23.50	20.50

F			
E			
D			
C			
B			
A	01-SEP-2009	(PC0001)	Ken
REV	DATE	FILE	BY

DRAWN:	Ken
CHECKED:	Lily Chou
APPROVAL:	Chao Peng
GENERAL TOLERANCE:	.X=±0.20 .XX=±0.15
UNIT:	MM
SCALE:	1:1
SHEET:	1 / 1
PROJECTION:	

DESCRIPTION:	1.25mm Wafer Straight SMT Type
PART NO:	WFVSM125-XX-CR

SIZE	A4
------	-----------