

Specifications:

Current Rating:7.0A AC/DC  
 Voltage Rating:250V AC/DC  
 Contact Resistance:10m Ohm.Max.  
 Insulation Resistance:1,000m Ohm.Min.  
 Withstanding Voltage:1,500V AC/Minute  
 Operating Temperature Range:-40°C To +105°C  
 Material and Finish:

Insulator:Nylon 66 (UL94V-2)  
 Insulator Color:Transparent White  
 Contact:Copper Alloy  
 Plated:Tin Plated

How To Order  
 WF1V396-XX

No. Of Positions  
 V: Straight Type

Dimension:

Pos	Dim. A	Dim. B	Pos	Dim. A	Dim. B	Pos	Dim. A	Dim. B
2	3.96	7.92	9	31.68	35.64	16	59.40	63.36
3	7.92	11.88	10	35.64	39.60	17	63.36	67.32
4	11.88	15.84	11	39.60	43.56	18	67.32	71.28
5	15.84	19.80	12	43.56	47.52	19	71.28	75.24
6	19.80	23.76	13	47.52	51.48	20	75.24	79.20
7	23.76	27.72	14	51.48	55.44			
8	27.72	31.68	15	55.44	59.40			

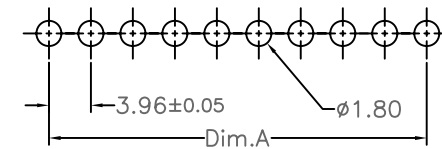

PCB LAYOUT

RoHS Compliant

F				DRAWN:	GENERAL TOLERANCE:		DESCRIPTION: 3.96mm Wafer Straight Type	SIZE <b>A4</b>
E			Ken	.X=±0.20 .XX=±0.15				
D			CHECKED:	UNIT: MM				
C			Lily Chou	SCALE: 1:1				
B			APPROVAL:	SHEET: 1 / 1	PART NO:	WF1V396-XX		
A	22-May-2014	(PC0001)	Ken	Chao Peng	PROJECTION:			
REV	DATE	FILE	BY					