

1

2

3

4

5

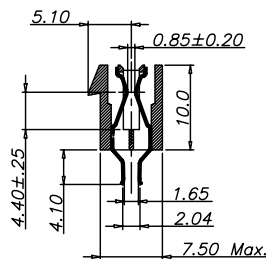
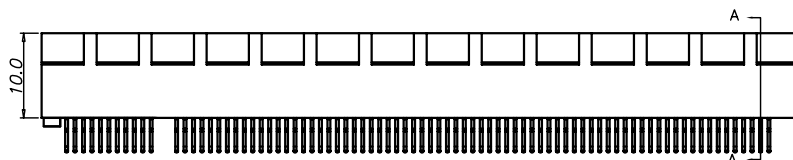
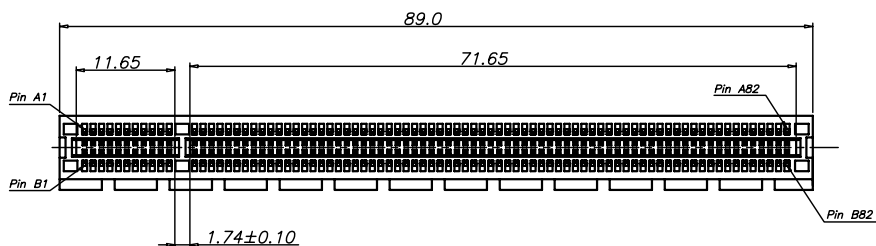
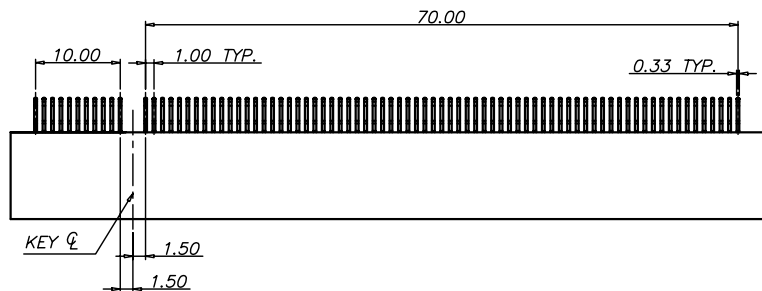

Electric Specifications

Current Rating:1.1Amps
 Rating Voltage: 250V AC
 Insulation Resistance:1000M Ohm Min At DC 500V
 Contact Resistance:30m Ohm Max At DC 100m Amps
 Withstanding Voltage:1 Minute At 750V r.m.s Min
 Temperature Range:-40°C~85°C

*Mechanical Characteristics:

- 1:Insertion Force: 1.15N per contact pair Max.
- 2:Extraction Force: 0.15N per contact pair Min.
- 3.Durability rating:50 Cycles

Materials:

Insulator:High Temp. Plastic (Nylon 66 UL94V-0)
 Insulator Color:Balck
 Terminal :Copper Alloy
 Plating:Selective Gold Plated

How To Order

PCIECP10-164GX

- Blank Selective Gold 1u"
- G3: Selective Gold 3u"
- G15: Selective Gold 15u"
- No.of Positions
- Clamping Plate Type

RoHS Compliant

				DRAWN: WGL	GENERAL TOLERANCE: .X=±0.2 .XX=±0.15			
E				CHECKED: Jeremy Liu	UNIT: MM		DESCRIPTION:	SIZE
D				APPROVAL: Mike Wu	SCALE:2:1	PCI-E 164 Connector Clamping plate type (大夹脚夹板式)	A4	
C					SHEET: 1 / 2	PART NO:		
B					PROJECTION:	PCIECP10-164GX		
A	04-Mar-2020	(PC0001)	WGL					
REV	DATE	FILE	BY					

A

B

C

D