

Specifications  
 Current Rating: 1.0A AC/DC  
 Voltage Rating: 250V AC/DC  
 Contact Resistance: 30m ohm. Max  
 Insulation Resistance: 1000Mohm min  
 Withstanding Voltage: 250V(r.m.s) For one Minute  
 Operating Temperature Range: -40°C to 85°C  
 Materials:  
 Insulator: High Temp. Plastic (LCP UL94V-0)  
 Color: Natural Color  
 Contact: Phosphor Bronze  
 Plated: Contact Gold Plated 3u"  
 Solder Tail Gold Plated 1u"  
 How To Order:  
 BBP10-XXX-330-01

- Without Metal Tab
- Total Height
- G: Gold Plated
- T: Tin Plated
- No. of Positions
- P: Plug

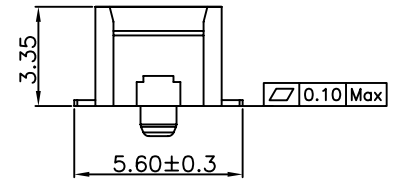

Pin No	A	B	C	D	Pin No	A	B	C	D
09	8.30	3.00	4.00	7.10	21	14.30	9.00	10.00	13.10
11	9.30	4.00	5.00	8.10	23	15.30	10.00	11.00	14.10
13	10.30	5.00	6.00	9.10	25	16.30	11.00	12.00	15.10
15	11.30	6.00	7.00	10.10	31	19.30	14.00	15.00	18.10
17	12.30	7.00	8.00	11.10	41	24.30	19.00	20.00	23.10
19	13.30	8.00	9.00	12.10	51	29.30	24.00	25.00	28.10

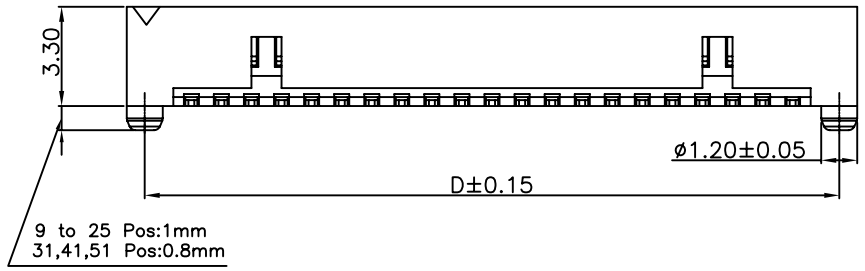
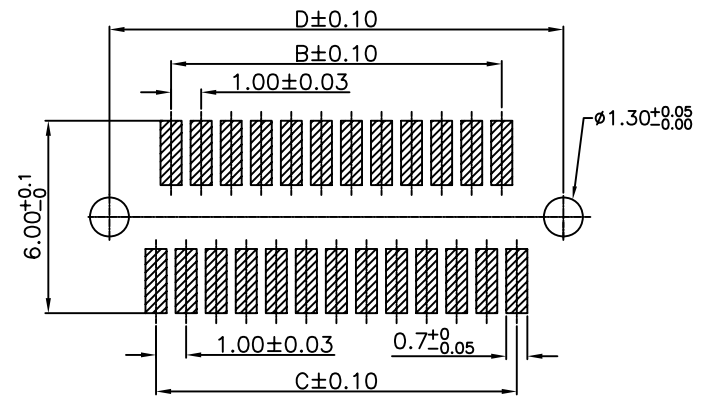

PCB LAYOUT

F				DRAWN:	GENERAL TOLERANCE:	<b>HOYATO</b> 东莞好亚通电子厂 Connector supplies	DESCRIPTION:	SIZE
E			Ken	.X=±0.20 .XX=±0.15				
D			CHECKED:	UNIT: MM	1.0mm Board To Board Plug 3.3mm Height			
C			Lily Chou	SCALE: 1:1				
B			APPROVAL:	SHEET: 1 / 1	PART NO:	A4		
A	10-SEP-2013	(PC0001)	Ken	PROJECTION:	BBP10-XXX-330-01			
REV	DATE	FILE	BY	Chao Peng				